



THE HYPHE
VAIL

Event rooms Capacity chart

| LEVEL | EVENT ROOM | DIMENSIONS | | CAPACITY | | | | | |
|----------------------|-------------------------------------|----------------|--------------|----------|-----------|------------|---------|-----------|---------|
| | | L X W X H (FT) | AREA (SQ.FT) | THEATRE | CLASSROOM | CONFERENCE | U-SHAPE | RECEPTION | BANQUET |
| LOBBY | Sun Up | 34 x 20 x 9 | 680 | 65 | 35 | 20 | 20 | 50 | 40 |
| | Sun Down | 40 x 35 x 9 | 1,400 | 110 | 80 | 30 | 30 | 130 | 90 |
| | Après Deck | Irregular | 2,625 | - | - | - | - | - | 60 |
| CONFERENCE | Grand Ballroom | 68 x 122 x 13 | 8,286 | 1,000 | 550 | - | - | 1,000 | 750 |
| | Grand Ballroom Foyer | 103 x 28 | 2,884 | - | - | - | - | 450 | - |
| | Salon E | 34 x 68 x 13 | 2,312 | 250 | 150 | - | 50 | 250 | 170 |
| | Salon F | 34 x 68 x 13 | 2,312 | 250 | 150 | - | 50 | 250 | 170 |
| | Salon A, B, C, D, G, H, I, J (each) | 17 x 27 x 13 | 459 | 45 | 24 | 20 | 15 | 40 | 30 |
| | Blue Sky | 40 x 35 x 9 | 1,400 | 110 | 80 | 30 | 30 | 130 | 90 |
| | Game Creek | 34 x 20 x 9 | 680 | 50 | 35 | 20 | 20 | 50 | 40 |
| 2ND | Colorado Ballroom | 54 x 81 x 11 | 4,400 | 430 | 260 | - | - | 450 | 300 |
| | Salon 1 | 40 x 40 x 11 | 1,667 | 140 | 84 | 32 | 39 | 90 | 120 |
| | Salon 2 | 41 x 51 x 11 | 2,125 | 180 | 120 | 40 | 50 | 140 | 160 |
| | Lodgepole Boardroom | 25 x 21 x 11 | 543 | - | - | 16 | - | - | - |
| | Berry Picker | 25 x 38 x 11 | 1,001 | 95 | 44 | 28 | 30 | 60 | 72 |
| | Mountain View | 58 x 25 x 11 | 1,450 | 110 | 80 | 40 | 36 | 130 | 100 |
| | Mountain View 1 | 29 x 25 x 11 | 725 | 50 | 35 | 20 | 20 | 50 | 40 |
| | Mountain View 2 | 29 x 25 x 11 | 725 | 50 | 35 | 20 | 20 | 50 | 40 |
| Eagle Bahn Boardroom | 25 x 21 x 11 | 543 | - | - | 16 | - | - | - | |



THE HYPHE

VAIL

Event rooms Floor plans

CONFERENCE LEVEL

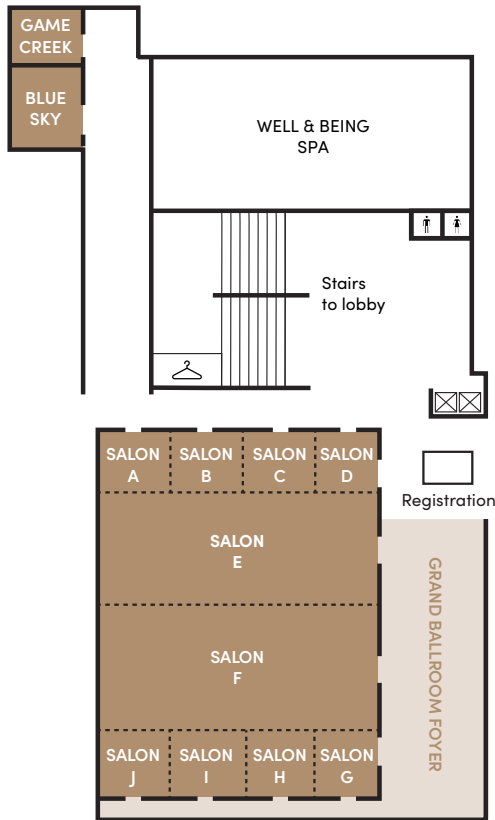

LOBBY LEVEL

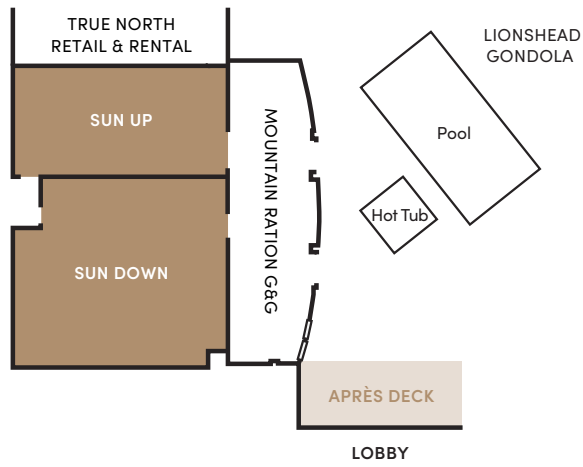

2ND LEVEL

